

09/08/99

STATE	STATE PROJECT REFERENCE NO.	SHEET NO.	TOTAL SHEETS
N.C.	51358	RW01	04

STATE OF NORTH CAROLINA
DIVISION OF HIGHWAYS
WILKES COUNTY

PROJECT: 51358

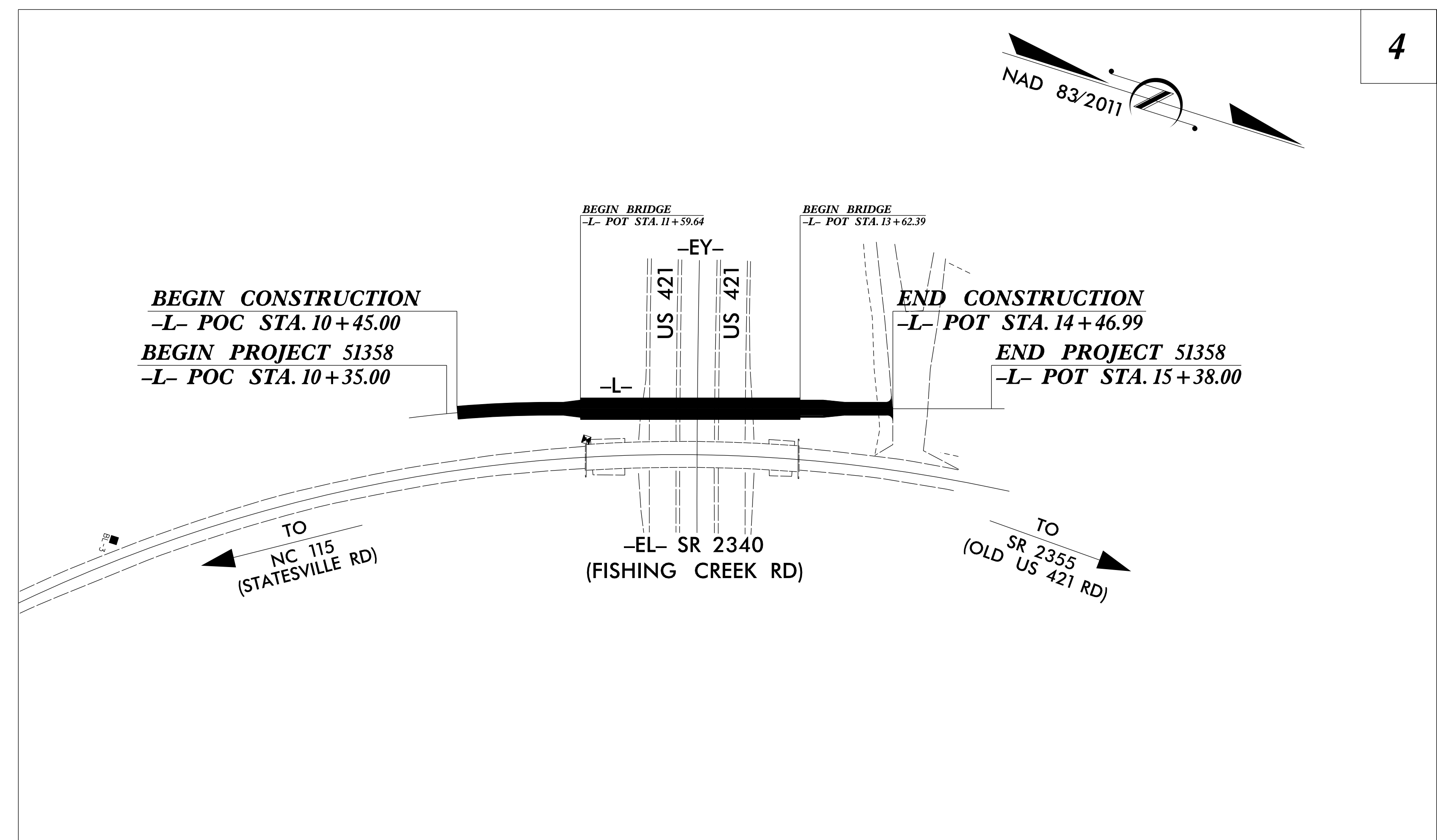
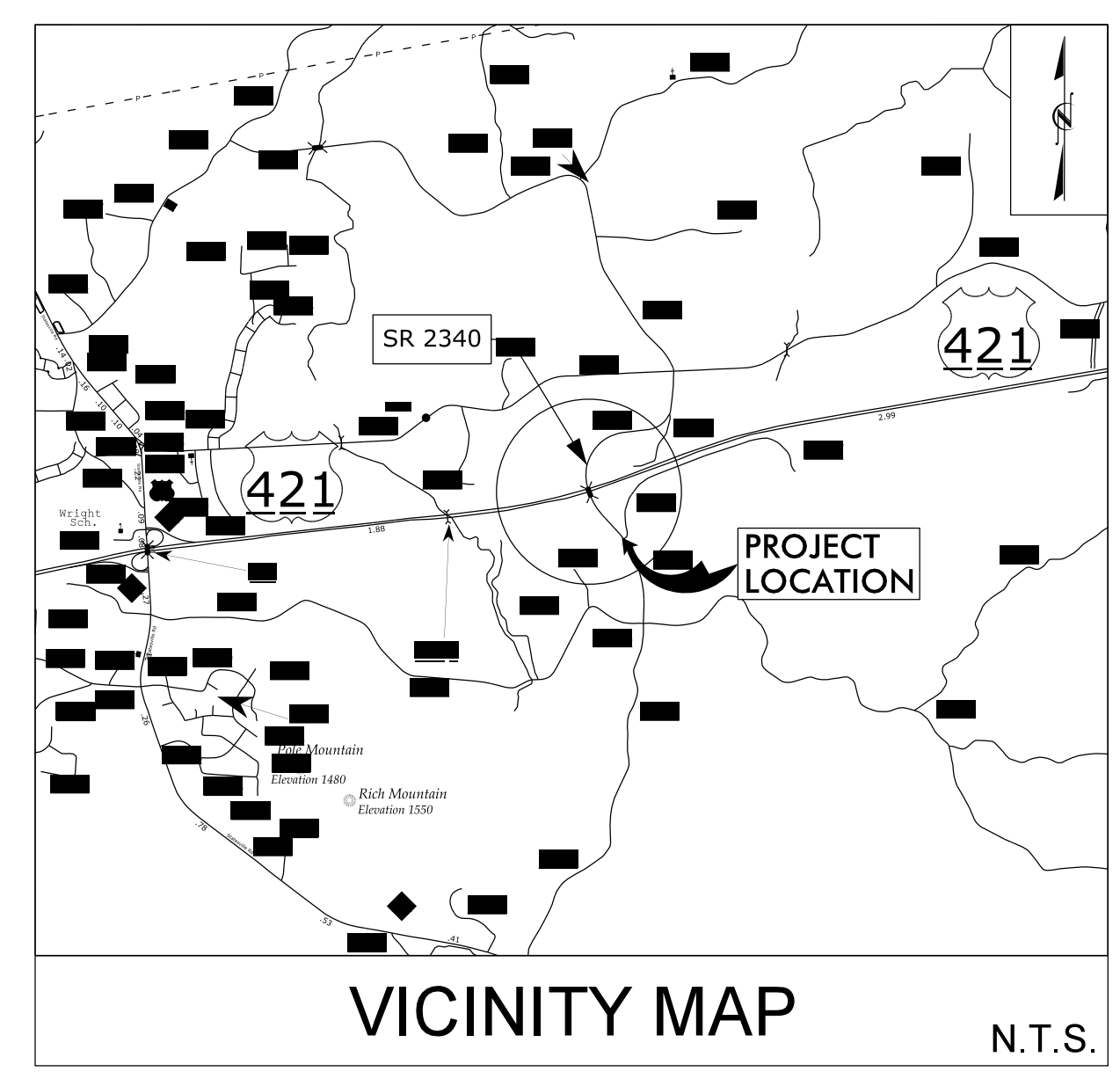

DOCUMENT NOT CONSIDERED FINAL
UNLESS ALL SIGNATURES COMPLETED

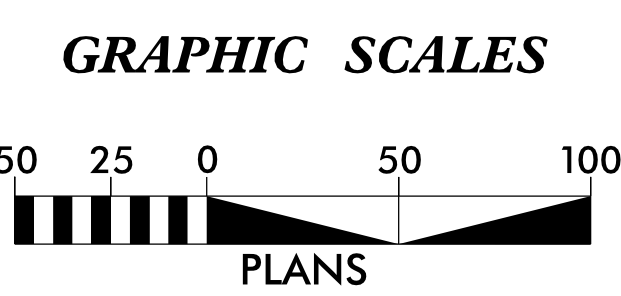

DATUM DESCRIPTION
THE LOCALIZED COORDINATE SYSTEM DEVELOPED FOR THIS PROJECT IS BASED ON THE STATE PLANE COORDINATES ESTABLISHED BY NCGS FOR MONUMENT "GPS 51358-2" WITH NAD 83(NA2011) STATE PLANE GRID COORDINATES OF NORTHING: 876631.9959(ft) EASTING: 1388631.4554(ft) ELEVATION: 1193.029(ft) THE AVERAGE COMBINED GRID FACTOR USED ON THIS PROJECT (GROUND TO GRID) IS: 0.999941100 THE N.C. LAMBERT GRID BEARING AND LOCALIZED HORIZONTAL GROUND DISTANCE FROM "GPS 51358-2" TO -L- STATION 10+00.00 IS S 32-16'47" E 385.52(ft) ALL LINEAR DIMENSIONS ARE LOCALIZED HORIZONTAL DISTANCES VERTICAL DATUM USED IS NAVD 1988 (GEOID88 CONUS)

PREPARED IN THE OFFICE OF:
**NORTH WILKESBORO
LOCATION & SURVEYS UNIT**
709 STATESVILLE RD.
336-903-9501

**PROFESSIONAL LAND
SURVEYOR**

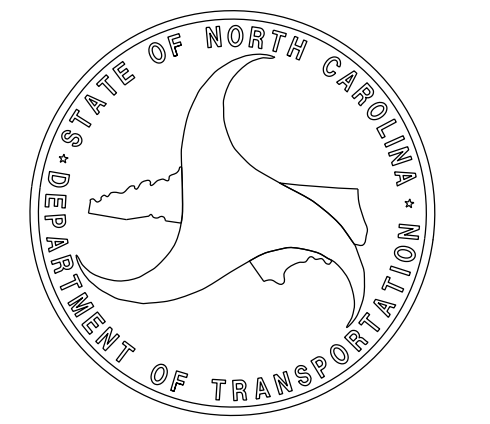

RIGHT OF WAY DATE:
NA

LETTING DATE:
AUGUST 15, 2024

DocuSigned by:
R. Landon Wagner
94066137FD3042D
SIGNATURE: P.E.

csmaxim AT LS-329547L
01-AUG-2024 15:05
L:\OLD_D\NWILKES\51358\roadway7-31-24\Electronic Files\150_001_51358_LS_RW01.dgn

